

TILE  
SANITARY COVE

NEW HINGES

BUILD SOFFIT OVER NEW TALL CABINET

(2) OVENS  
M-W/CONVECTION STD.  
(1) WARMING DRAWER

★ ★  
SIDE-ACCESS BASE & UPPER CABINET  
SPICE PANTRY

OVEN BOX FULL-HEIGHT

REMOVE STAIR ATTACH TO DOOR  
(2) FULL-WIDTH ROLL-OUTS

SUPPORT SAW?

FARMHOUSE SINK

CONVERT (2) FALSE FRONTS TO SHALLOW DRAWERS

MODIFY FRAME & DOORS IF NEEDED

COUNTERS UNDER MOUNT SINK

NEW FAUCET

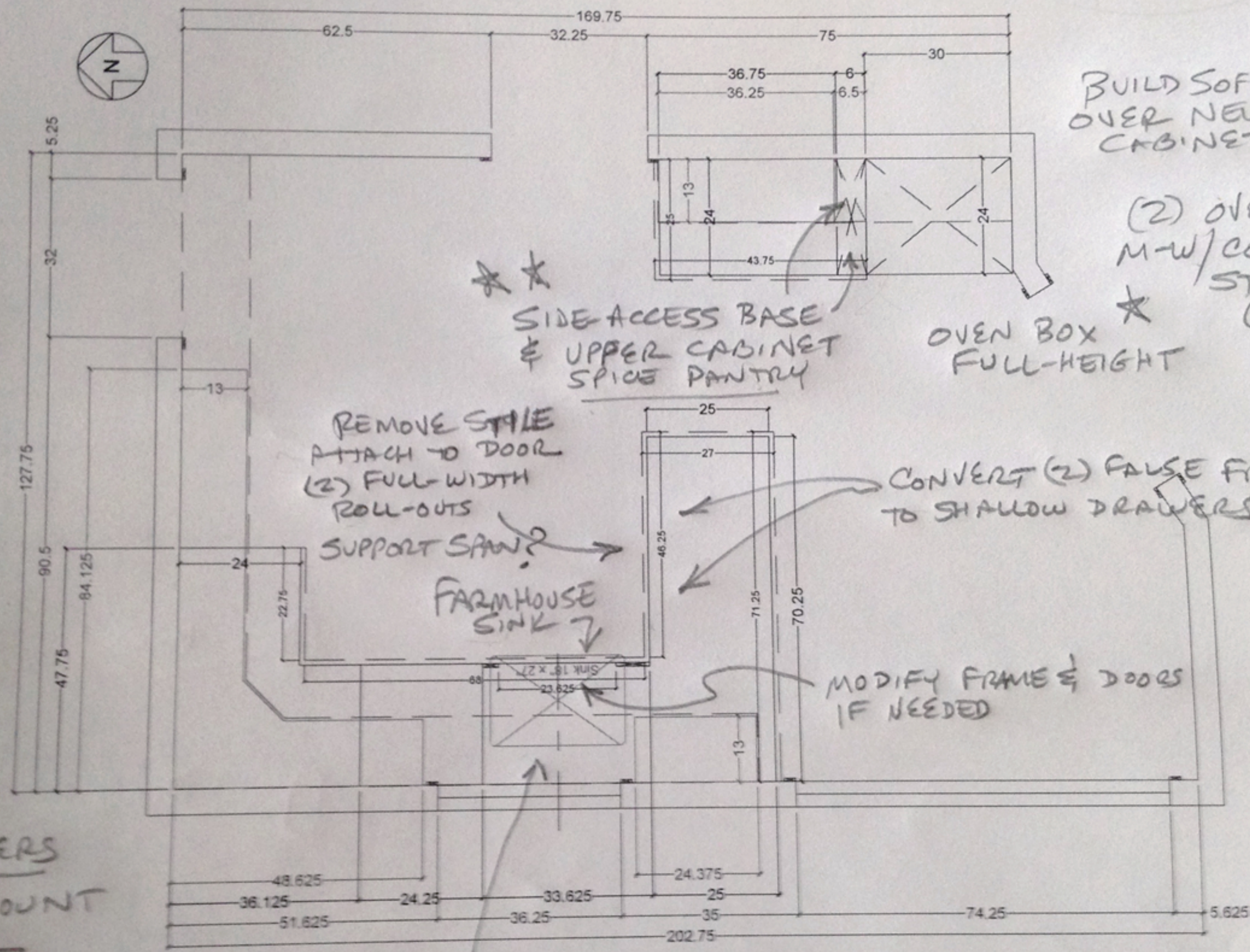

PLAN View

|                                |                     |                      |
|--------------------------------|---------------------|----------------------|
| Name: McChesney, Richard & Kay | Scale: 3/8" = 1' 0" | Size: 'A' 8.5" x 11" |
|                                |                     | Dr. by: Brian        |
| Project: KITCHEN Remodel       | REV:                | Date: 05.13.18       |