

## FRAMED MIRRORS

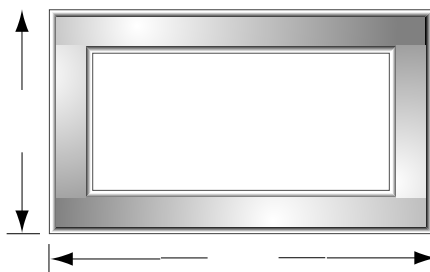

### FRAMED MIRRORS

(3/16" CLEAR MIRRORS WITH 1" BEVEL AND 2-1/2" WOOD FRAME)

25" X 24".....	\$134.60	49" X 33".....	\$350.40
31" X 30".....	\$202.65	61" X 33".....	\$435.85
37" X 33".....	\$264.90	73" X 33".....	\$521.35

**CUSTOM SIZES.....\$33.55 PER S.F.**

**(5 SQUARE FOOT MINIMUM CHARGE ON CUSTOM ITEMS.)**

CROWN MOULDING MAY BE ADDED TO THESE MIRRORS.

NOTE THAT THE CROWN WILL INCREASE THE  
OVERALL SIZE OF THE ITEM.

2-1/4" CROWN FOR 25", 31", AND 37" MIRRORS.....ADD \$59.00

3-3/8" CROWN FOR 49", 61", AND 73" MIRRORS.....ADD \$99.00

ARCH WITH APPLIQUE.....ADD \$99.00

ALL PRICING ON THIS PAGE IS FOR PAINT WHITE, ALDER,  
OAK, BIRCH, KNOTTY PINE, MAPLE OR CHERRY.

DEDUCT 5% FOR UNFINISHED, ADD 10% FOR GLAZED FINISHES.

CALL OUR FACTORY FOR A QUOTE ON ANY OTHER MATERIAL.

## MEDICINE CABINETS & TRIVIEWS

### STANDARD MEDICINE CABINETS

**\$271.75 each**

16.5" X 26.5" O.D.

(Surface or Recess Mount)

**WINGED MEDICINE CABINET** \$418.40 each

**CORNER MEDICINE CABINET** \$397.80 each

### CHOICE OF THREE STYLES:

**CB-1** (1/2" Overlay, Wood Frame)

**CB-2** (Full Overlay, Wood Frame)

**CB-3** (Full Overlay, All Mirror Front)

46.0" X 26.5" O.D. (Fits Standard Rough Opening)

16.5" X 26.5" O.D. (Fixed Wood Shelves)

### TRADITIONAL TRIVIEWS

49" X 33" TRIVIEW..... \$1,006.95

61" X 33" TRIVIEW..... \$1,253.60

73" X 33" TRIVIEW..... \$1,500.20

**CUSTOM SIZES.....\$101.00 Per S.F.** (5 SQUARE FT. MINIMUM CHARGE ON CUSTOM ITEMS)

3-3/8" CROWN ..... ADD \$99.00 GALLEY RAIL IN CENTER..... ADD \$49.00

THESE TRIVIEWS ARE SURFACE MOUNTED WITH  
BEVELED, **RECESSED CENTER MIRRORS &**  
MEDICINE CABINETS ON THE LEFT & RIGHT ENDS

### ALL MIRROR TRIVIEWS

TRIPLE MEDICINE CABINETS WITH BUTT DOORS, SURFACE MOUNT

	<u>STYLE A:</u>	<u>STYLE B:</u>	<u>STYLE C:</u>
31" X 30".....	\$ 579.15	\$ 579.15	\$ 637.05
37" X 33".....	\$ 750.30	\$ 750.30	\$ 836.35
49" X 33".....	\$ 1,006.95	\$ 1,006.95	\$ 1,107.65
61" X 33".....	\$ 1,253.60	\$ 1,253.60	\$ 1,378.95
73" X 33".....	\$ 1,500.20	\$ 1,500.20	\$ 1,650.25

**(ADD \$109.00 SET-UP CHARGE FOR RECESSED CONSTRUCTION)**

**STYLE A:** PLAIN MIRRORS WITH WOOD PERIMETER FRAME WHICH IS PART OF EACH DOOR.

**STYLE B:** MIRRORS ONLY, WITH 1" BEVELED PERIMETER (NO WOOD FRAME).

**CUSTOM SIZES.....\$101.00 Per S.F.**

**STYLE C:** WOOD PERIMETER FRAME AND BEVELED MIRRORS.

**CUSTOM SIZES.....\$111.10 Per S.F.**

(5 SQUARE FT. MINIMUM CHARGE ON CUSTOM ITEMS)

OUR MEDICINE CABINETS AND TRI-VIEWS ARE TYPICALLY 4-3/8" DEEP  
WITH ADJUSTABLE GLASS SHELVES UNLESS SPECIFIED OTHERWISE.

**ALL PRICING ON THIS PAGE IS FOR PAINT WHITE, ALDER,  
OAK, BIRCH, KNOTTY PINE, MAPLE OR CHERRY.  
DEDUCT 5% FOR UNFINISHED, ADD 10% FOR GLAZED FINISHES.  
CALL OUR FACTORY FOR A QUOTE ON ANY OTHER MATERIAL.**

**\*ALL TRIVIEWS ARE SURFACE MOUNTED, UNLESS SPECIFIED IN WRITING !!**

## Traditional Triviews

(Recessed Center)

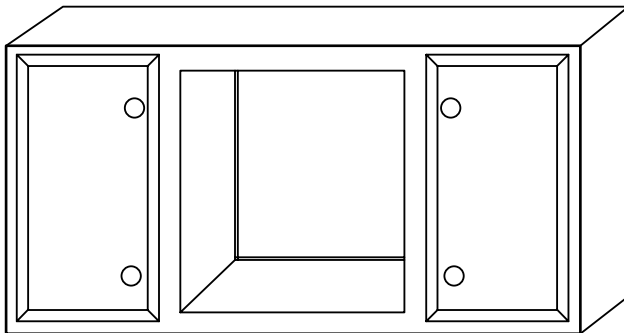

## All Mirror Triviews

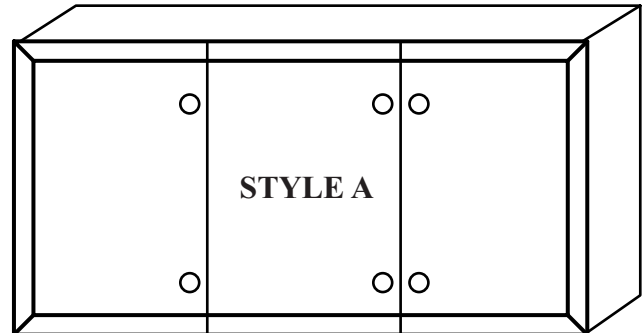

WOOD FRAME & STRAIGHT MIRROR

Recessed  
Med. Cab.

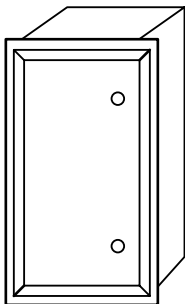

Corner Medicine  
Cabinet

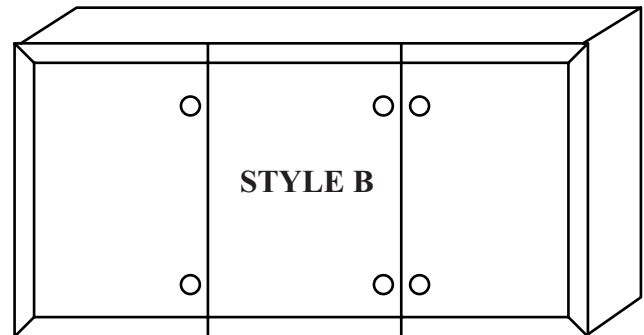
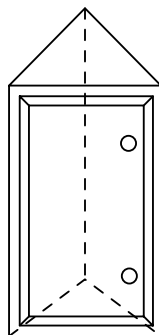

BEVELED MIRROR ONLY

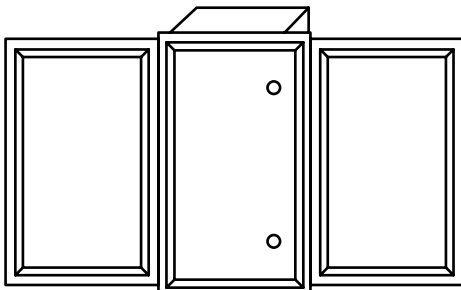

Winged Medicine Cabinet

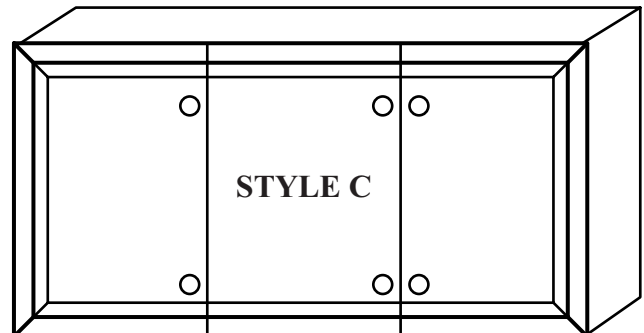

WOOD FRAME & BEVELED MIRROR

○ Indicates Standard Hinge Location

## LIGHT BARS

WOOD FRONT			
SIZE	SHALLOW (1-1/2" DEEP)	BOXED (4-3/8" DEEP)	NUMBER OF LIGHTS
19"X5-1/4"	\$126.85	\$139.65	3
25"X5-1/4"	\$165.90	\$180.15	3
31"X5-1/4"	\$201.50	\$220.45	4
37"X5-1/4"	\$234.70	\$257.20	5
49"X5-1/4"	\$313.00	\$334.25	6
61"X5-1/4"	\$361.50	\$397.45	8
73"X5-1/4"	\$423.10	\$468.15	9
THESE LIGHT FIXTURES HAVE SOLID WOOD FRONTS WITH A PERIMETER EDGE DETAIL TO MATCH OUR VANITIES (SPECIFY EDGE DETAIL).			

BEVELED MIRROR FRONT			
SIZE	SHALLOW (1-3/4" DEEP)	BOXED (5-1/4" DEEP)	NUMBER OF LIGHTS
19"X6-1/4"	\$232.75	\$246.85	3
25"X6-1/4"	\$267.00	\$265.85	3
31"X6-1/4"	\$345.30	\$367.75	4
37"X6-1/4"	\$413.15	\$437.45	5
49"X6-1/4"	\$520.55	\$552.50	6
61"X6-1/4"	\$645.85	\$685.50	8
73"X6-1/4"	\$744.35	\$792.90	9
THESE LIGHT FIXTURES HAVE AN ALL MIRROR FACE WITH 1" BEVEL TO MATCH OUR "STYLE B" ALL MIRROR TRIVIUMS			

SPECIFY MATERIAL, FINISH, AND TRIM: ANTIQUE BRASS, BRITE BRASS, CHROME, BRUSHED CHROME, OR WHITE

### WOOD FRONTS

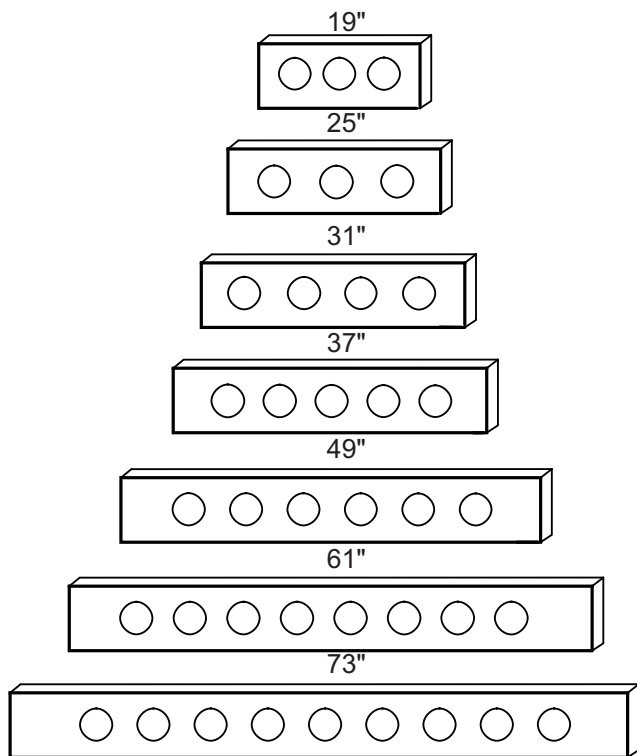

### BEVELED MIRROR FRONTS

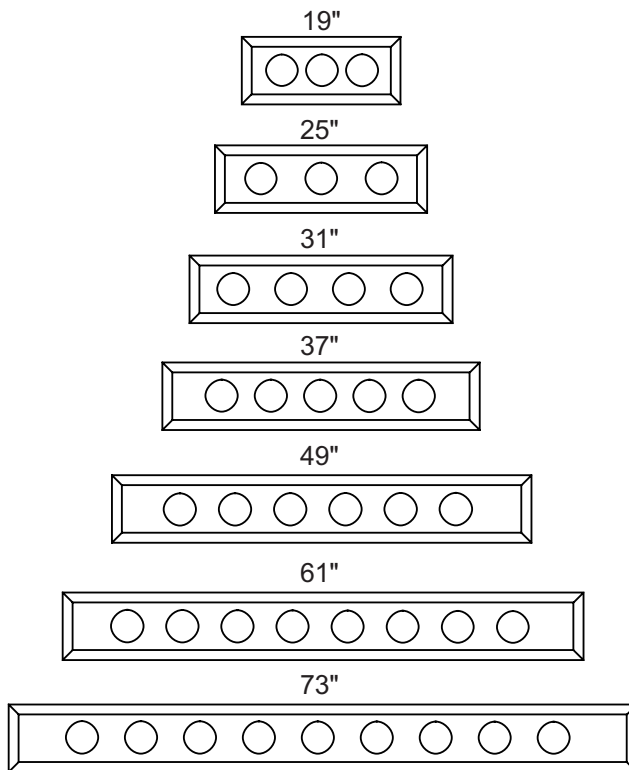

PRICES ABOVE ARE FOR ANY STANDARD FINISH (INCLUDING WHITE WASHED AND UNFINISHED)

CUSTOM SIZES ARE AVAILABLE. CONSULT FACTORY FOR ANY ITEM NOT LISTED ABOVE.

**NOTE:** LIGHT BULBS ARE NOT PROVIDED WITH THESE FIXTURES. LOW WATT BULBS ARE RECOMMENDED.

## TYPICAL LINEN CABINET CONFIGURATIONS

(THESE ARE ONLY SUGGESTIONS, YOU CAN CREATE YOUR OWN LAYOUTS.)

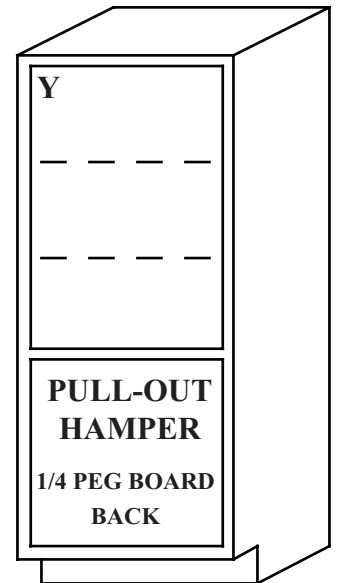
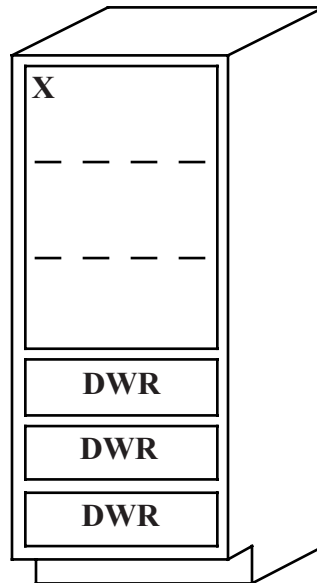
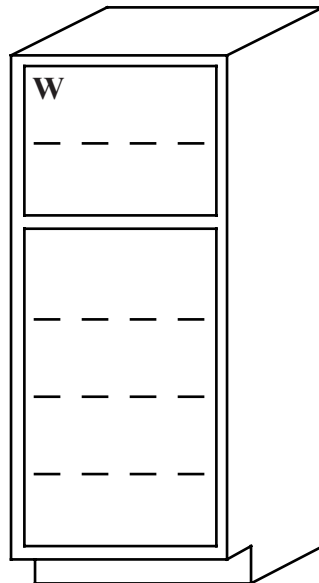
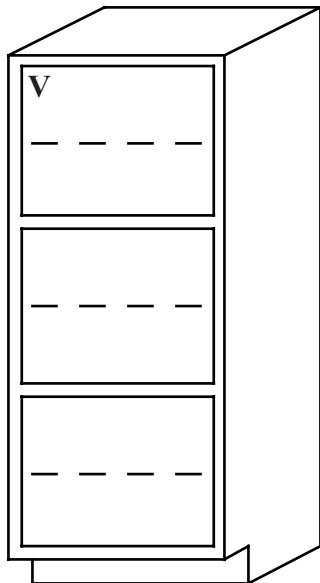
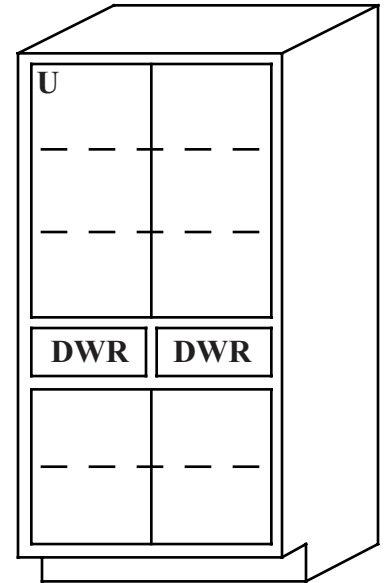
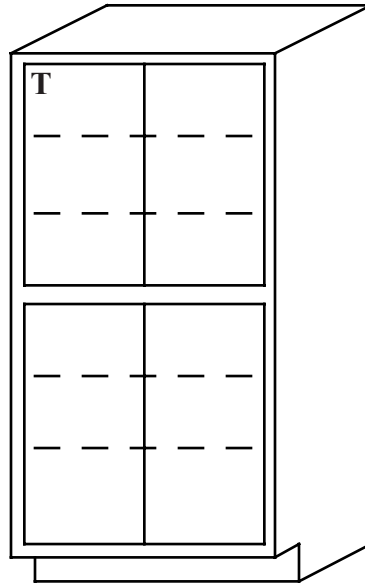
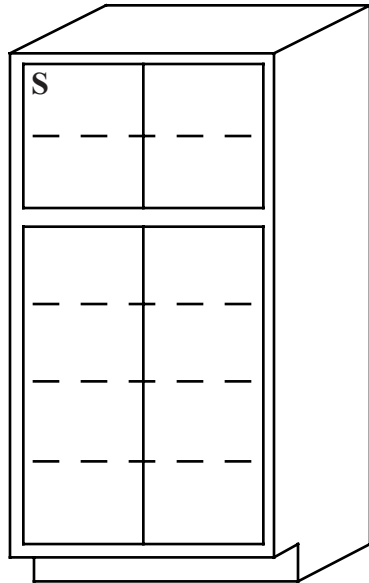

ADJUSTABLE SHELVES ARE INCLUDED IN THE BASIC SQUARE FOOT LINEN CABINET PRICING.

## CUSTOM LINEN & OVERJOHN PRICING

See Worksheet on the following page.

Priced per square foot. (5 square foot minimum)		PAINTED WHITE	STAINED & WHITEWASHED	
DOOR STYLE	DEPTH	MDF & HARDWOOD	ALDER, BIRCH, or OAK or PINE	CHERRY or MAPLE
GROUP I (RAISED PANEL)	12" MAX.	\$88.55	\$101.90	\$118.25
	16" MAX.	\$93.05	\$106.45	\$121.05
	24" MAX.	\$97.40	\$115.10	\$126.80
GROUP II (RECESSED PANEL)	12" MAX.	\$84.00	\$98.60	\$109.20
	16" MAX.	\$88.25	\$101.40	\$114.65
	24" MAX.	\$92.45	\$106.25	\$120.10
GROUP III (SOLID)	12" MAX.	\$76.40	\$87.90	\$99.30
	16" MAX.	\$80.20	\$92.30	\$104.25
	24" MAX.	\$84.00	\$96.65	\$109.25
GROUP IV (SPECIALTY DOORS)	12" MAX.	\$101.90	\$117.15	\$132.50
	16" MAX.	\$107.05	\$123.05	\$139.15
	24" MAX.	\$115.10	\$128.85	\$145.70

ADD 10 % TO ABOVE PRICES FOR ALL PLYWOOD CONSTRUCTION.

(TO MATCH AN ELITE VANITY)

### ADD ON FOR THE FOLLOWING ACCESSORIES:

DRAWERS	(PLYWOOD BOX WITH DUAL EPOXY SLIDES)	X \$89.00 EA
PULL OUTS	(PLYWOOD BOX WITH DUAL EPOXY SLIDES)	X \$89.00 EA
ROLL OUT HAMPER	(27" MAX WIDTH WITH FULL EXTENSION SLIDES)	X \$189.00 EA

## CUSTOM LINEN WORKSHEET

USE THIS PAGE TO SKETCH & PRICE YOUR LINEN CABINET.  
SEE PAGE A5 FOR SUGGESTED LAY-OUTS.

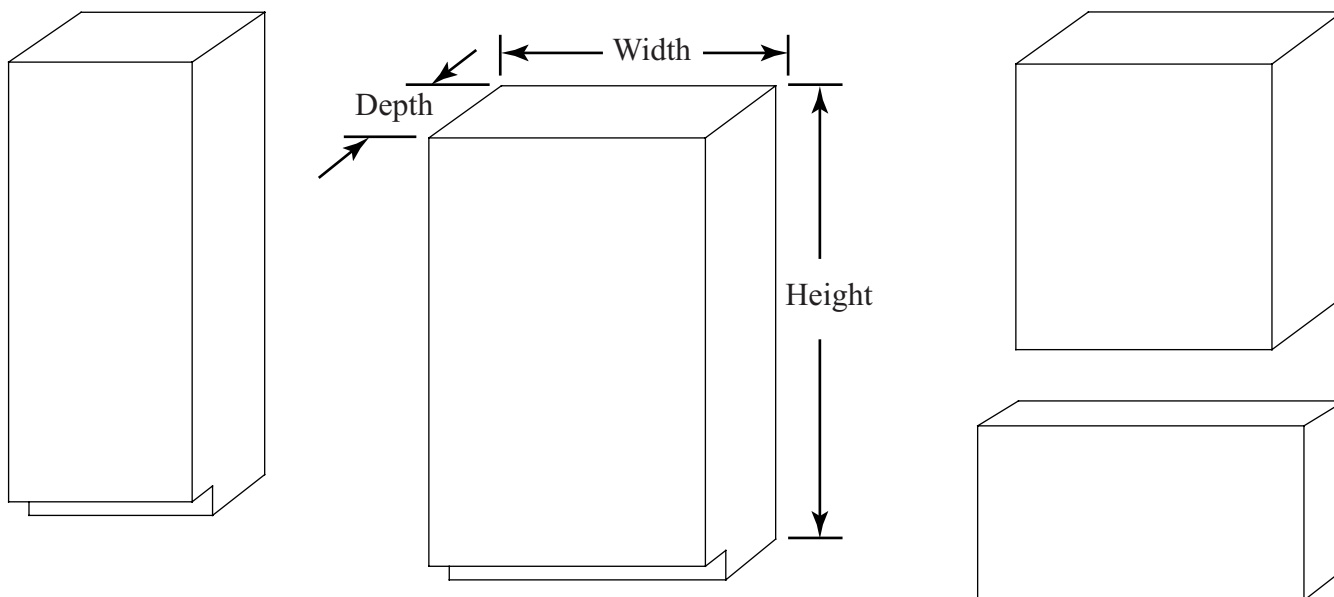

- (A) CHOOSE THE DOOR STYLE: \_\_\_\_\_  
CHOOSE THE MATERIAL: \_\_\_\_\_  
CHOOSE THE FINISH: \_\_\_\_\_
- (B) USE THE INFORMATION FROM "A" ALONG WITH THE DEPTH  
OF YOUR CABINET TO FIND THE CORRECT  
PER SQUARE FOOT PRICE ON PAGE A6: \_\_\_\_\_ \$/Square Foot
- (C) CALCULATE SQUARE FOOTAGE OF YOUR CABINET:  
WIDTH (LEFT TO RIGHT) MULTIPLIED BY HEIGHT DIVIDED BY 144  
\_\_\_\_\_ " (W) X \_\_\_\_\_ " (H) ÷ 144 = \_\_\_\_\_ S.F.
- (D) MULTIPLY "B" & "C" TO OBTAIN LIST PRICE FOR CABINET  
\_\_\_\_\_ \$/S.F. (B) X \_\_\_\_\_ S.F. (C) = \_\_\_\_\_ SUBTOTAL
- (E) ADD ON FOR ANY ACCESSORIES (DRAWERS, HAMPERS, MOULDINGS, ETC.).

## STANDARD MISCELLANEOUS CABINETS

DESCRIPTION	PAINTED WHITE	STAINED & WHITEWASHED	
GROUP I (RAISED PANEL DOORS)	MDF & HARDWOOD	OAK, ALDER, BIRCH, OR KNOTTY PINE	CHERRY or MAPLE
21 X 21 CORNER VANITY	\$549.05	\$631.35	\$713.75
21X26X8 OVERJOHN	\$269.15	\$309.55	\$349.90
24X36X8 OVERJOHN	\$445.90	\$512.70	\$579.60
21X12X24 HAMPER	\$353.40	\$406.40	\$459.45

### GROUP II (RECESSED PANEL DOORS)

21 X 21 CORNER VANITY	\$534.80	\$615.00	\$695.25
21X26X8 OVERJOHN	\$254.95	\$293.10	\$331.45
24X36X8 OVERJOHN	\$383.05	\$440.60	\$497.95
21X12X24 HAMPER	\$320.20	\$368.25	\$378.75

### GROUP III (SOLID DOORS)

21 X 21 CORNER VANITY	\$521.80	\$600.00	\$678.30
21X26X8 OVERJOHN	\$233.65	\$268.65	\$303.70
24X36X8 OVERJOHN	\$351.00	\$403.75	\$456.30
21X12X24 HAMPER	\$320.20	\$368.25	\$416.20

### GROUP IV (SPECIALTY DOORS)

21 X 21 CORNER VANITY	\$582.30	\$669.65	\$757.00
21X26X8 OVERJOHN	\$288.25	\$331.45	\$374.70
24X36X8 OVERJOHN	\$434.00	\$499.05	\$564.25
21X12X24 HAMPER	\$360.50	\$414.60	\$468.65

MAGAZINE & TP RACK	\$188.60	\$216.90	\$245.20
--------------------	----------	----------	----------

ALL PRICES ABOVE ARE FOR PREFINISHED CABINETS.  
DEDUCT 15% FOR UNFINISHED CABINETS.  
ADD 15% FOR A GLAZED FINISH.

SHELVES ARE ADJUSTABLE AND MADE OF MELAMINE.  
CONCEALED HINGES & FINGER PULLS ARE STANDARD.



# Classic Bath Designs, Inc.

SUN VALLEY • CALIFORNIA

JUNE 1, 2005  
(818) 767-1144  
(818) 767-1278 FAX

## 21 x 26 STANDARD OVERJOHN

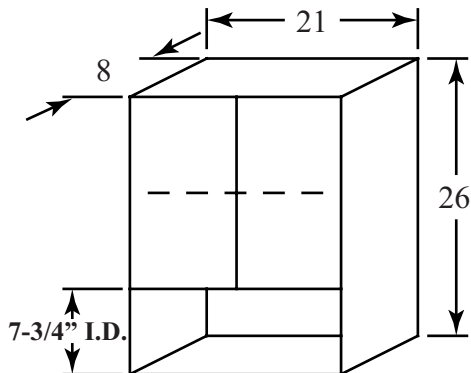

FRAMELESS CONSTRUCTION  
(1 ADJUSTABLE SHELF)

## 24 x 36 STANDARD OVERJOHN

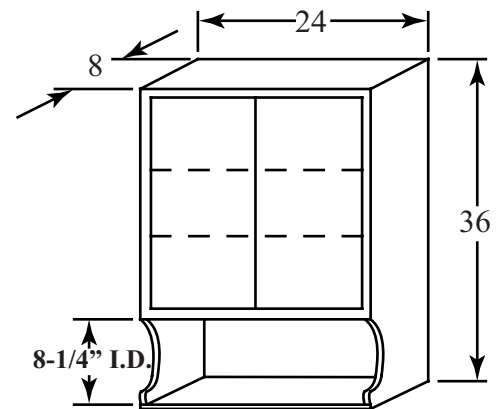

FACE FRAME CONSTRUCTION  
(2 ADJUSTABLE SHELVES)

## 21 x 21 CORNER VANITY

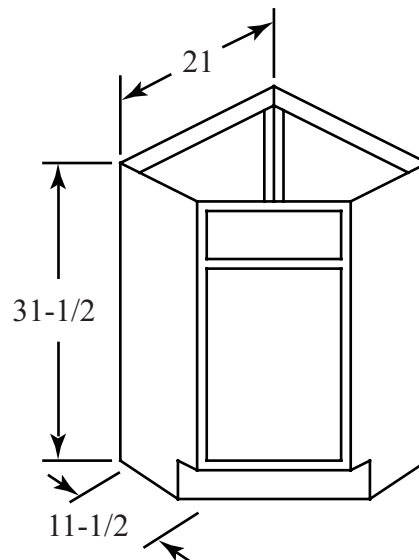

## STANDARD HAMPER

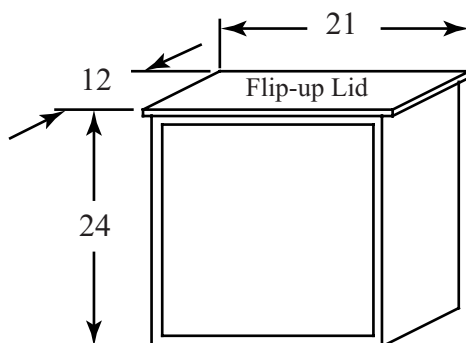

FREE STANDING WITH  
PEG BOARD BACK

## TOILET PAPER & MAGAZINE RACK

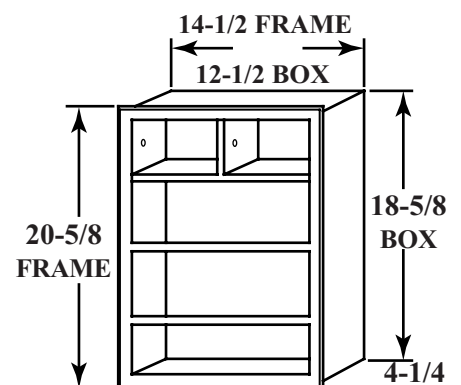

MOUNT IN WALL BETWEEN STUDS  
OR IN THE SIDE OF A  
VANITY OR LINEN CABINET

## MOULDINGS & MISCELLANEOUS ITEMS

BASE SHOE	(3/8" X 3/4")	X \$ 4.00 LF =
SCRIBE	(3/16" X 3/4")	X \$ 4.00 LF =
2-1/4" CROWN	COVERS 1-5/8" (H) X 1-9/16" (V)	X \$ 12.00 LF =
3-3/8" CROWN	COVERS 2-1/4" (H) X 2-3/8" (V)	X \$ 12.00 LF =
GALLEY RAIL	72" LENGTHS (2-1/4" TALL X 3/4" THICK)	X \$ 15.00 LF =
LARGE FLUTED OVERLAYS	(3-1/2" WIDE, 5/8" THICK)	X \$ 8.00 LF =
SMALL FLUTED OVERLAYS	(1-3/4" WIDE, 5/8" THICK)	X \$ 8.00 LF =
LARGE PLINTH BLOCKS	(3-5/8" X 3-5/8")	X \$ 12.00 EA =
SMALL PLINTH BLOCKS	(1-7/8" X 1-7/8")	X \$ 10.00 EA =
APPLIED 1/4 POST		X \$ 149.00 EA =
APPLIED 1/2 POST		X \$ 169.00 EA =
STANDARD APPLIQUE #SPR 789	(16-1/4" X 3-3/4")	X \$ 89.00 EA =
STANDARD APPLIQUE #SPR 404	(14" X 2-3/4")	X \$ 89.00 EA =
TOE-KICK SKINS	(4" X 96" X 1/4")	X \$ 29.00 EA =
SHORT FILLERS (YOU SHOULD NOT NEED THESE)	(3" X 48" MAX)	X \$ 29.00 EA =
TALL FILLERS (YOU SHOULD NOT NEED THESE)	(3" X 96" MAX)	X \$ 49.00 EA =
ROUGH TOP (CDX PLYWOOD)	SPECIFY 3/4" FOR TILE OR 5/8" FOR GRANITE)	X \$ 6.00 SF =
EXTRA FINISH (PAINT OR STAIN)	(QUART)	X \$ 35.00 EA =
EXTRA FINISH (PAINT OR STAIN)	(PINT)	X \$ 25.00 EA =
EXTRA FINISH (PAINT OR STAIN)	(4 OZ.)	X \$ 15.00 EA =



APPLIQUE #SPR789

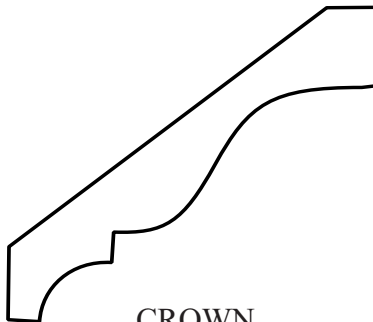

CROWN  
(2-1/4" or 3-3/8")



SCRIBE

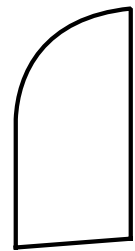

BASE



APPLIQUE #SPR404



FLUTED OVERLAY

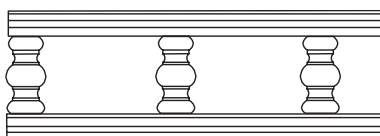

GALLEY RAIL

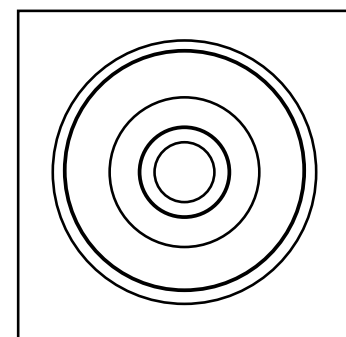

PLINTH BLOCK  
(3-5/8" or 1-7/8")